

Parts List for Walking Floor Kit

Item No.	Part No.	Description	Qty
1	OT*****	Oil tank (subject to kit specification)	1
2	AF83	Filler breather assembly	1
3	NR1544	Low pressure elbow - 1½"	1
4	VS7	Low pressure shut off valve - 1½"	1
5	NR1541	Adaptor assembly - 1½" push-on	1
6	SF97/3	Jubilee clip - 1½"	2
7	OP496/78	Low pressure pipe - 1½"	1
10	OP87/6/36/HP	XHP flexible hose assembly - ¾"	1
11	NR611/42	Adaptor - ¾" to ¾" BSP	3
12	DPP45F/SC	Dowty seal - ¾"	4
13	NR611/27	Adaptor - ¾" to 1" BSP	1
14	OP87/8/36	HP flexible hose assembly - 1"	1
15	NR611/43	Adaptor - 1" to 1" BSP	3
16	NR1637	Tee adaptor 12 - 1" female BSP	1
17	DPP45H/SC	Dowty seal - 1"	2
18	OP87/8/60	HP flexible hose assembly - 1"	2
19	NR1662	Bulkhead connector - 1"	1
20	OP87/8/84	HP flexible hose assembly - 1"	1
21	V011250H	Relief cartridge	1
22	PM478	Filter cartridge	1
23	OP87/6/48/HP	XHP flexible hose assembly - ¾"	1
24	NR1663	Bulkhead connector - ¾"	1
25	OP87/6/84/HP	XHP flexible hose assembly - ¾"	1
26	QDC075F/W	Quick release coupling - ¾" female	1
27	QDC100F/W	Quick release coupling - 1" female	1
28	NR611/41	Adaptor - 1" to 1½" BSP	2
29	DPP45K/SC	Dowty seal - 1½"	2

PKS Pump Kit *

Item No.	Part No.	Description	Qty
8	NR1588	1½" push-on adaptor - 45 degree	1
9	EBA09022	Bent axis piston pump	1
11	NR611/42	Adaptor ¾" - ¾" BSP	1
12	DPP45F/SC	Dowty seal - ¾"	1

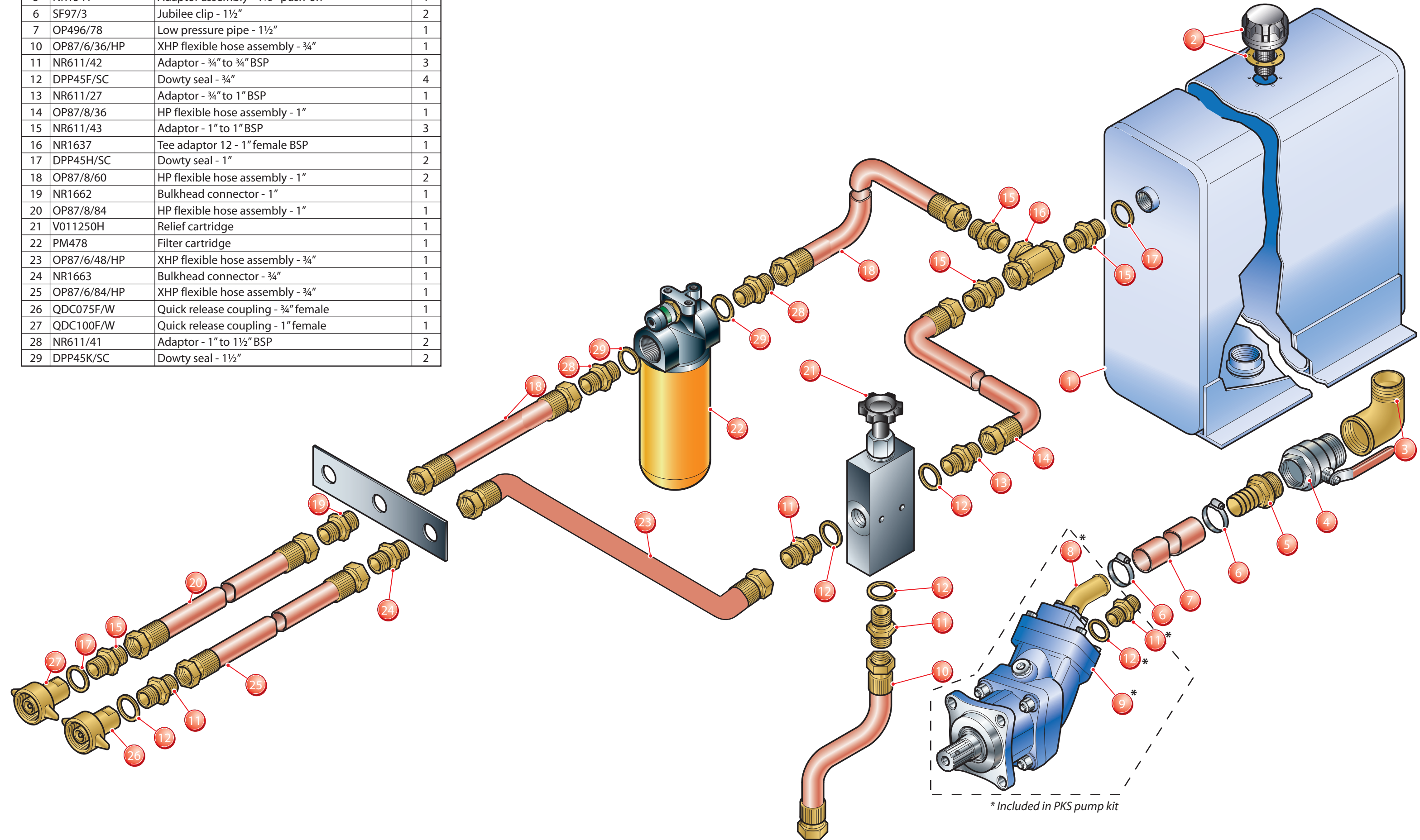

* Included in PKS pump kit

STANDARD WALKING FLOOR KIT HYDRAULIC LAYOUT

(1½" SUCTION LINE)