

Parts List for Walking Floor Kit

Item No.	Part No.	Description	Qty
1	OT*****	Oil tank (subject to kit specification)	1
2	AF83	Filler breather assembly	1
3	NR1642	Low pressure elbow - 2"	1
3A	NR1657	Adaptor 1½" to 2" BSP	1
4	VS6	Low pressure shut off valve - 2"	1
5	NR1643	Adaptor assembly - 2" push-on	1
6	SF97/4	Jubilee clip - 2"	2
7	OP506/2000	Low pressure pipe - 2"	1
10	OP87/6/36/HP	XHP flexible hose assembly - ¾"	1
11	NR611/42	Adaptor ¾" to ¾" BSP	3
12	DPP45F/SC	Dowty seal - ¾"	4
13	NR611/27	Adaptor ¾" to 1" BSP	1
14	OP87/8/36	HP flexible hose assembly - 1"	1
15	NR611/43	Adaptor - 1" to 1" BSP	3
16	NR1637	Tee adaptor 12 - 1" female BSP	1
17	DPP45H/SC	Dowty seal - 1"	2
18	OP87/8/60	HP flexible hose assembly - 1"	2
19	NR1662	Bulkhead connector - 1"	1
20	OP87/8/84	HP flexible hose assembly - 1"	1
21	V011250H	Relief cartridge	1
22	PM478	Filter cartridge	1
23	OP87/6/48/HP	XHP flexible hose assembly - ¾"	1
24	NR1663	Bulkhead connector - ¾"	1
25	OP87/6/84/HP	XHP flexible hose assembly - ¾"	1
26	QDC075F/W	Quick release coupling - ¾" female	1
27	QDC100F/W	Quick release coupling - 1" female	1
28	NR611/41	Adaptor - 1" to 1½" BSP	2
29	DPP45K/SC	Dowty seal - 1½"	2

PKS Pump Kit *

Item No.	Part No.	Description	Qty
8	NR1590	2" push-on adaptor - 45 degree	1
9	EBA09022	Bent axis piston pump	1
11	NR611/42	Adaptor ¾" - ¾" BSP	1
12	DPP45F/SC	Dowty seal - ¾"	1

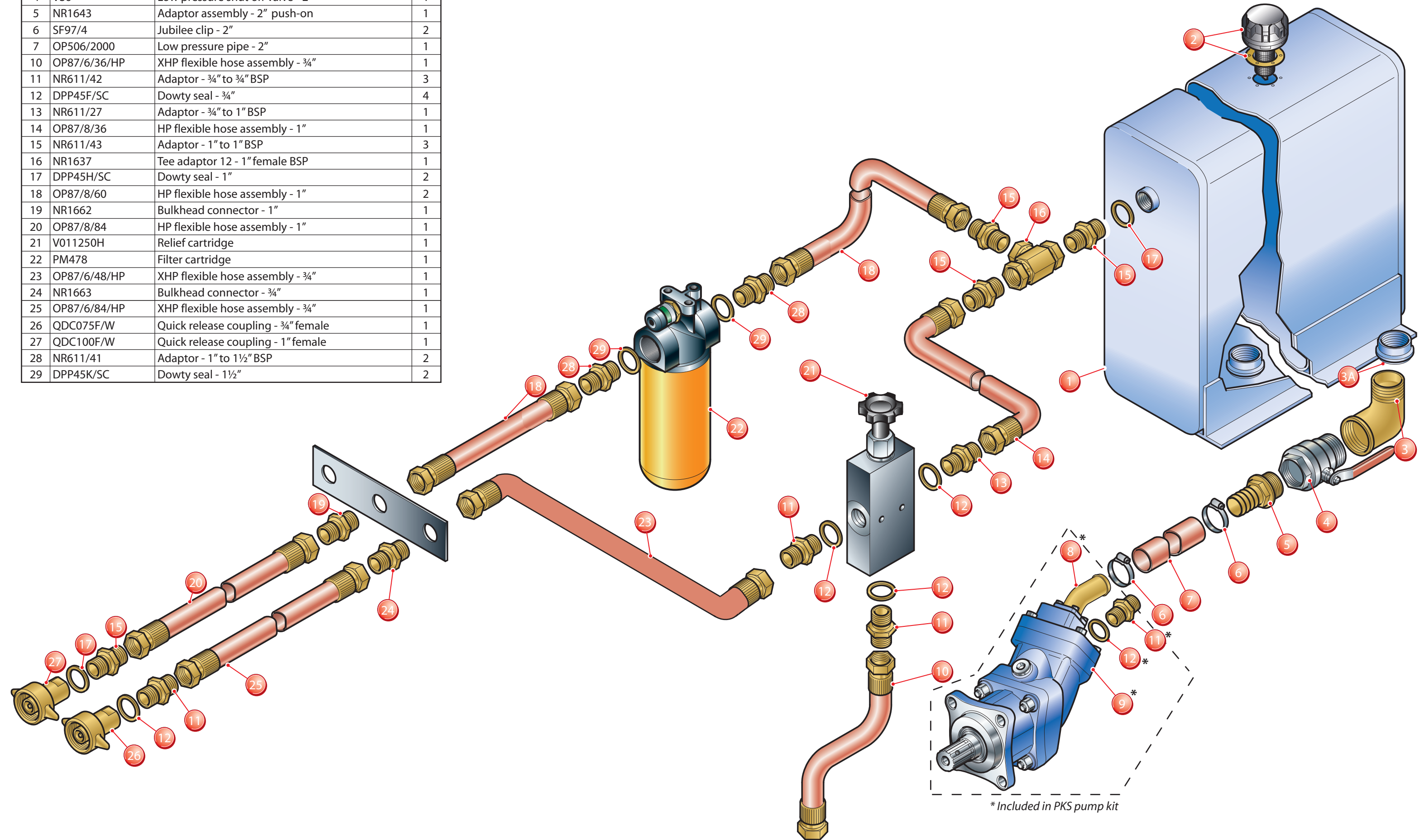

* Included in PKS pump kit