

CYLINDER ASSY PART No : RK254TS704500001

TUBE	BORE	O/DIA	LENGTH	STROKE	THRUST @ 135 bar
BASE RAM	254.00	276.23	943		
1ST INT (EXT) (RETRACT)	222.25	239.70	953	543	69.7 t 7.6 t
2ND INT (EXT) (RETRACT)	196.85	212.72	973	588	53.4 t 4.5 t
3RD INT (EXT) (RETRACT)	171.45	185.72	970	608	41.9 t 4.6 t
4TH INT (EXT) (RETRACT)	146.05	160.32	967	695	31.9 t 4.0 t
5TH INT (EXT) (RETRACT)	120.65	133.35	964	692	23.0 t 3.8 t
6TH INT (EXT) (RETRACT)	98.42	111.12	961	689	15.7 t 2.3 t
7TH INT (EXT) (RETRACT)	76.20	88.90	970	686	10.5 t 1.9 t

TOTAL STROKE	4500
SWEPT VOL (EXTEND)	109.5 Litre
SWEPT VOL (RETRACT)	13 Litre
OPERATING PRESSURE	135 bar
MAXIMUM PRESSURE	150 bar
CYLINDER WEIGHT DRY	365 est. kg

GENERAL DIMENSIONS					
A	1169	H	67	R	1" B.S.P
B	719	J	127	S	57
C	276	K	96	T	50
D	460	L	450	V	12°
E	360	M	50		
F	63.50	N	57		
G	302	P	1.25" B.S.P		

DIMENSIONS IN MILLIMETRES UNLESS STATED OTHERWISE

ALL INTER TUBES HARDCHROMED

AMENDMENTS

D.O. NOTES -

This drawing is the property and copyright of EDBRO PLC and must not be re-issued, copied or reproduced without their consent.

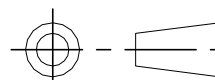

THIRD ANGLE PROJECTION



PROJECT CYLINDERS

TITLE	CYLINDER OUTLINE		EDBRO PLC BOLTON LANCASHIRE ENGLAND
DRAWN	R.W		
DATE	21-11-06		
DRG.No	4A78198_4500		